



FOR LEASE/Purchase Option

6655 Mid-Cities Ave., Beltsville, MD 20705

**FREESTANDING FLEX-INDUSTRIAL BUILDING
12,666 SQ. FT. (+/-) OVERALL**

- 8,000 SQ. FT. (+/-) WAREHOUSE & MAINTENANCE SHOP
- 4,666 SQ. FT. (+/-) PROFESSIONAL GRADE OFFICES
- I-2 ZONING (HEAVY INDUSTRIAL)
- ABUNDANT SURFACE PARKING
- FENCED OUTSIDE STORAGE
- 1.48 ACRE (+/-) LOT
- \$12.50 PSF (NNN) (negotiable)

FOR MORE INFORMATION CALL ...

Brian Hobbs

1-800-246-5555



Hobbs Associates, Inc.
Commercial/Industrial Real Estate

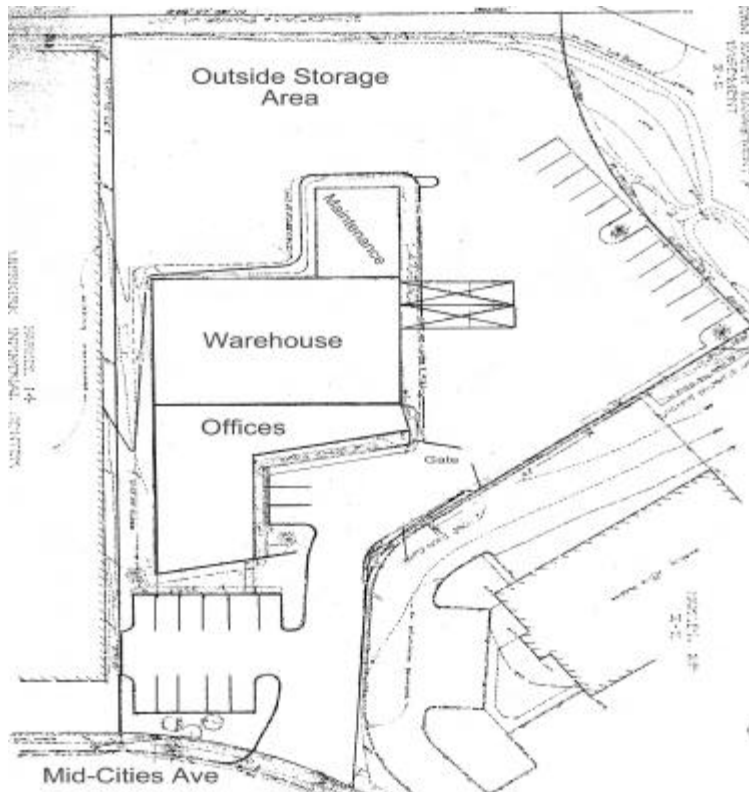

The information contained herein has been given to us by the owner of the property or obtained from sources we deem reliable. No warranty or representation, express or implied, is made as to the accuracy of the information contained herein, and same is submitted subject to errors, omissions, change of price, rental or other conditions, withdrawal without notice and to any special listing conditions imposed by our principals.